

XTOOL

自助服务终端 (落地式)

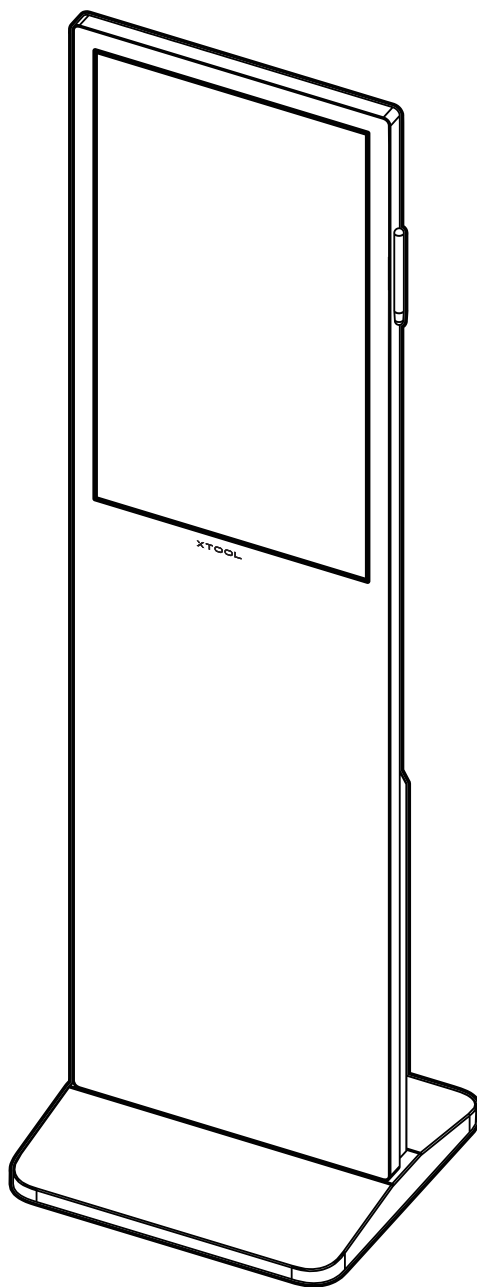

快速使用指南

物料清单 ----- 01

认识 xTool 自助服务终端（落地式）----- 02

安装 xTool 自助服务终端（落地式）-----04

使用 xTool 自助服务终端（落地式）----- 06

物料清单

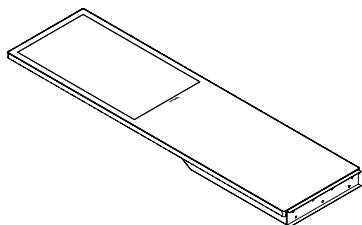

自助服务终端

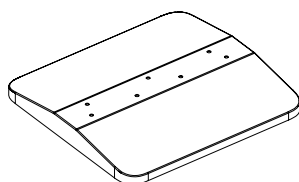

底座

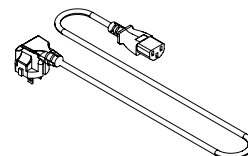

电源线

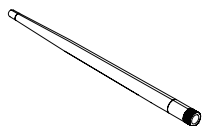

天线

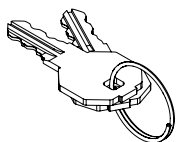

维护钥匙

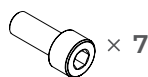

螺丝

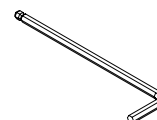

L型扳手

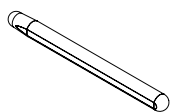

触控笔

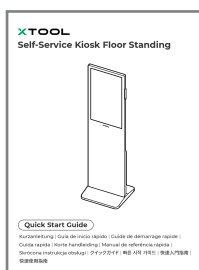

快速使用指南

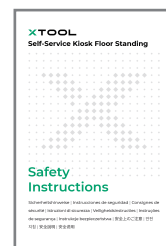

安全说明



发往不同国家和地区的电源线可能不同。

认识 xTool 自助服务终端 (落地式)

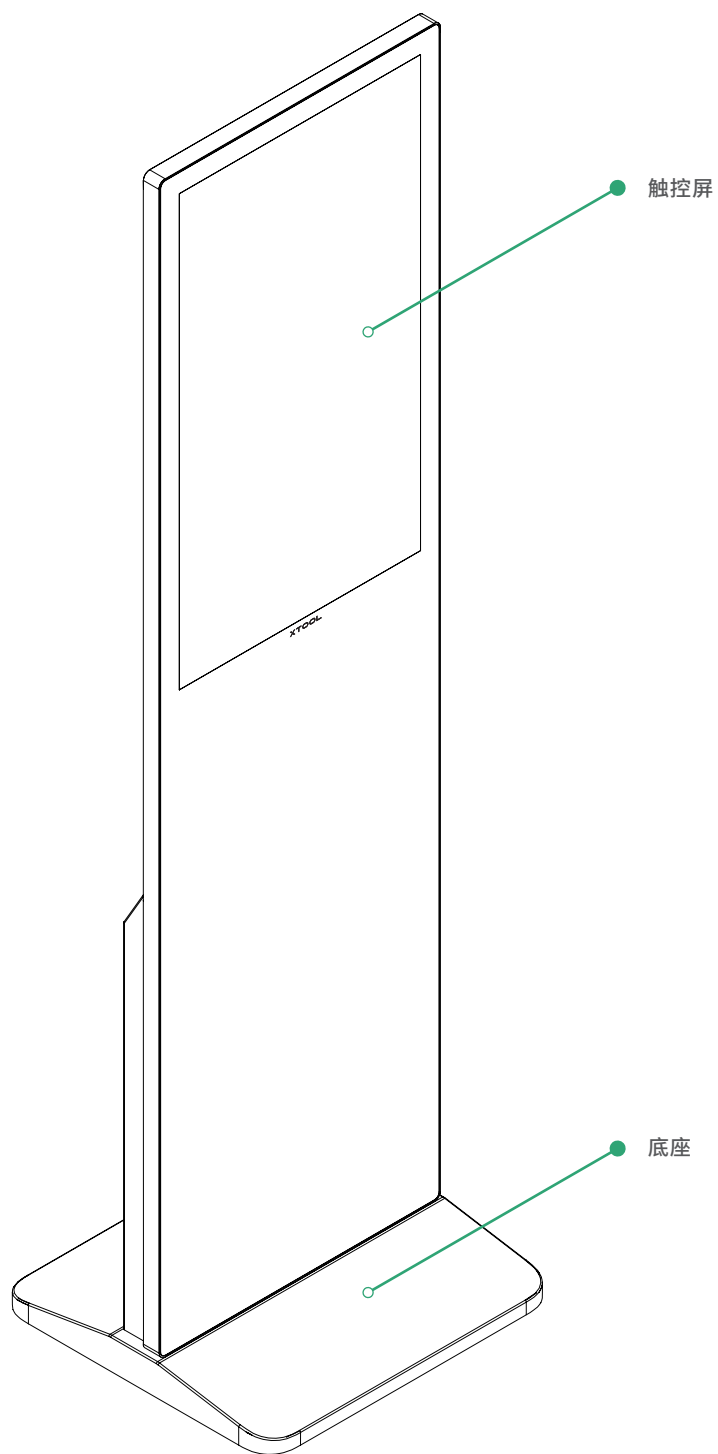

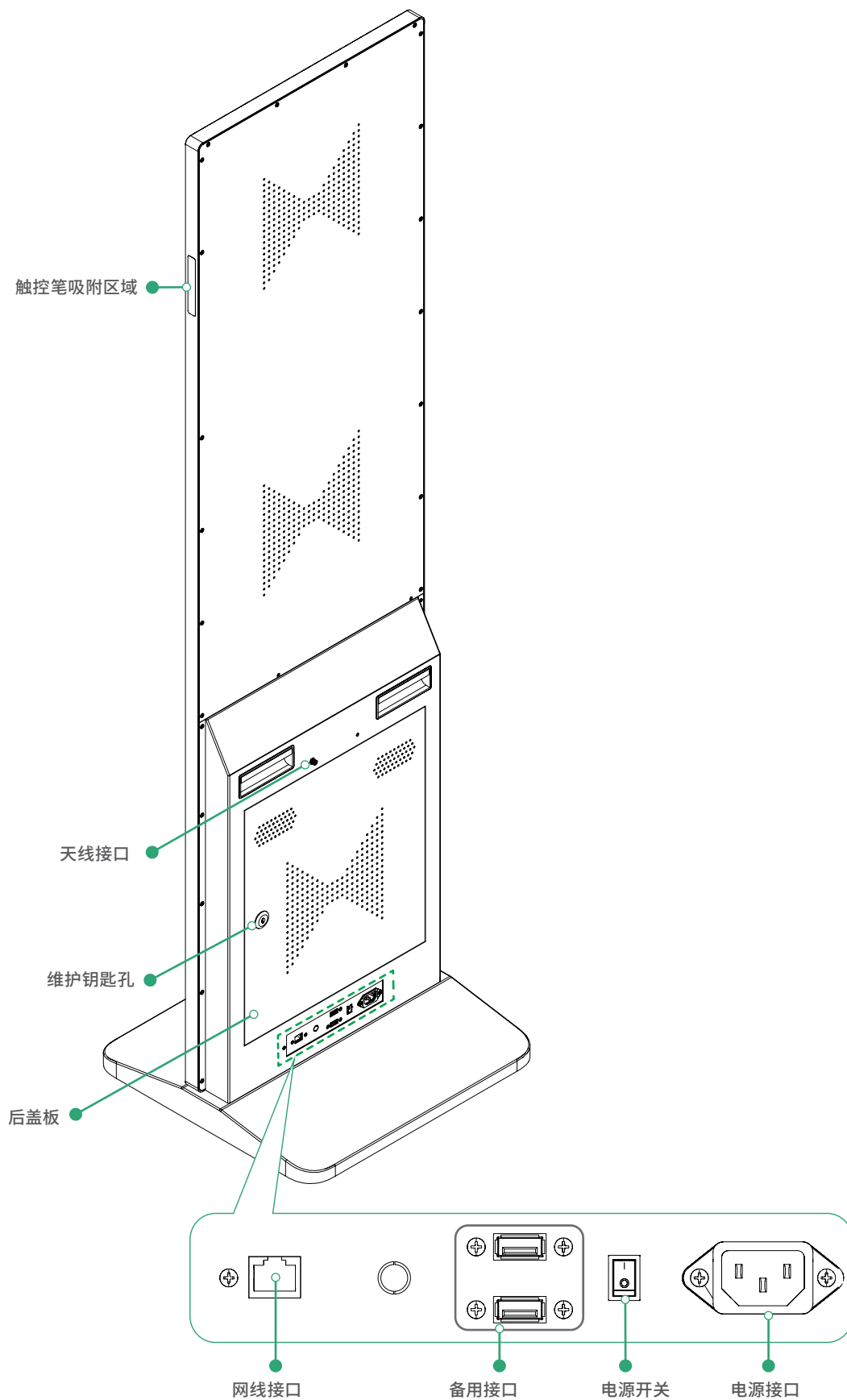

后盖板仅维修时可用维护钥匙打开。

安装 xTool 自助服务终端 (落地式)

1 安装底座

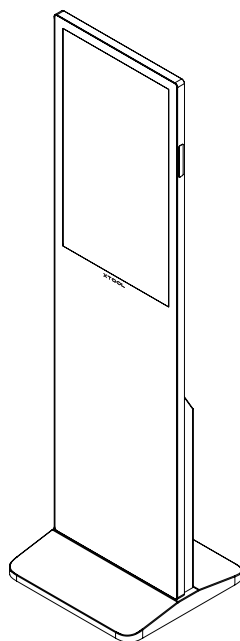
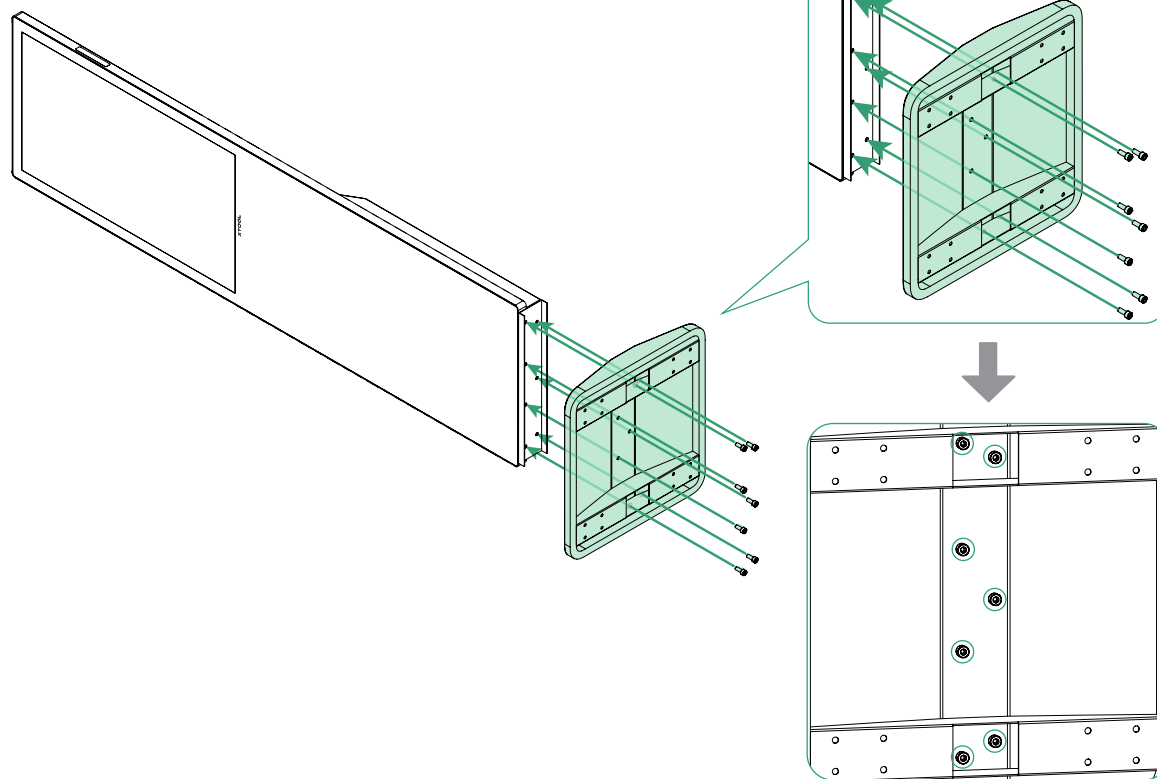
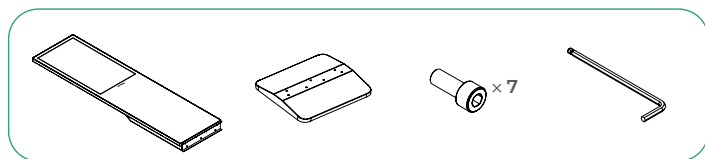

2 安装天线

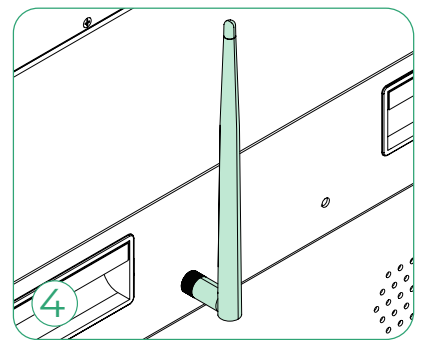
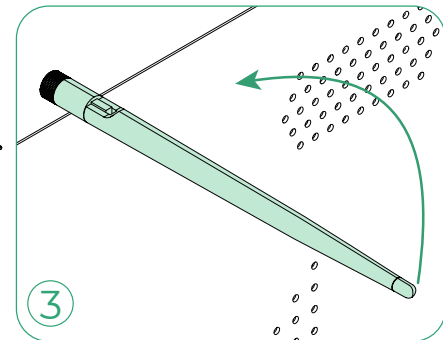
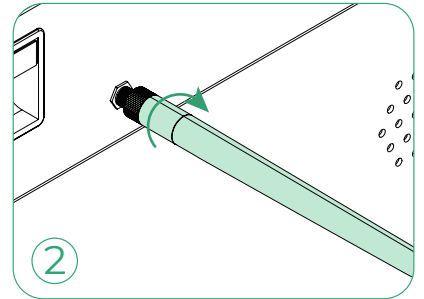
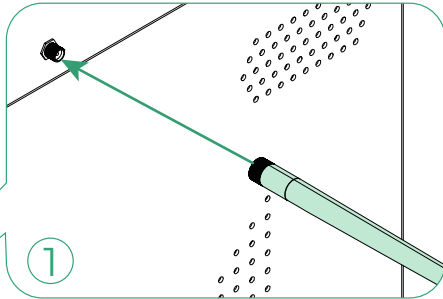
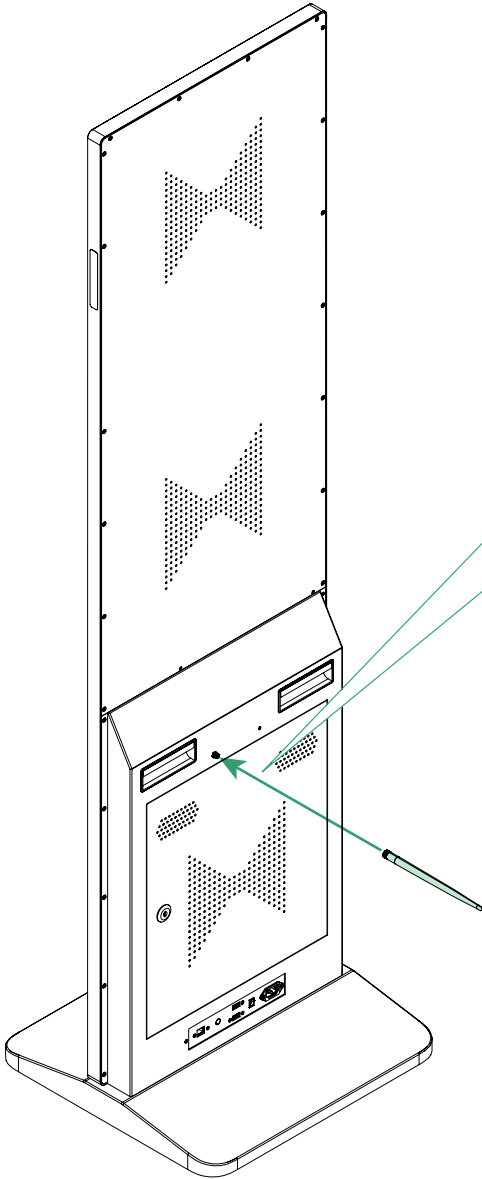
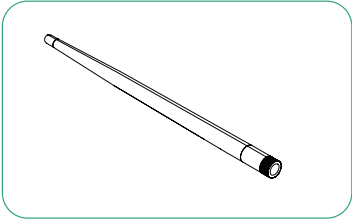

使用 xTool 自助服务终端（落地式）

插入电源线并开机

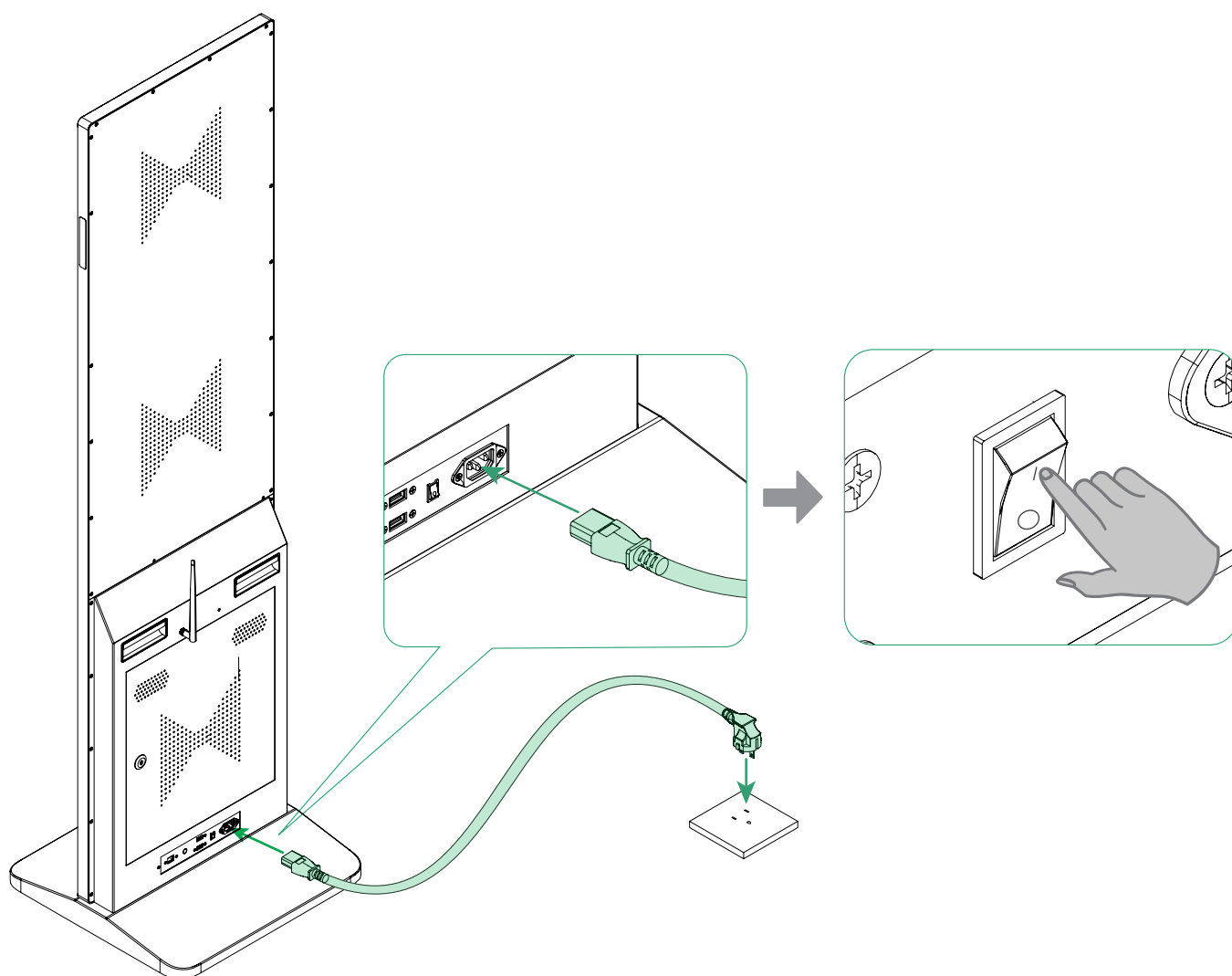
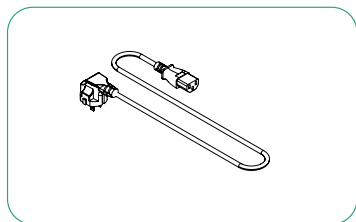

扫描二维码或访问链接查看如何搭配 xTool 机器使用完成加工。



s.makextool.com/wiki/self-service-kiosk

XTOOL